

October 2006 Room Keys

State/City – Casino	Key Front	Key Back
<p>California – Cache Creek Casino New “Loco Caliente” room key. Mfr: Plastic Print-A-Card.</p> <p>Contributor: Larry and Alice Kopp</p>	 <p>INSERT & REMOVE, THEN OPEN</p> <p>LOCOS CALIENTE MEXICAN CANTINA</p> <p>For room reservations and information, call 928-77-CACHE or visit cachecreek.com.</p>	<p>Operating Instructions</p> <p>Insert and Remove Keycard Magnetic Stripe Down</p>  <p>Introduzca y quite la tarjeta Introduire et retirer la carte-clé カードを挿入し、引き出す 挿入及抜出先カ、磁條向下</p> <p>Turn Handle While Green Light is Flashing</p>  <p>Gire la perilla cuando destelle la luz verde Tourner la poignée au clignotant vert 緑のライトが点滅している時にハンドルを回す 富録電光時信動門把手</p> <p>PLASTIC PRINT-A-CARD CO., LLC SYSTEM 06</p>
<p>California – Colusa Casino New room key, front side same as 1st issue, new backside design. Mfr: pcsisd.com.</p> <p>Contributor: Larry and Alice Kopp</p>	 <p>Enjoy Your Stay!</p> <p>COLUSA CASINO RESORT</p>	 <p>1. Insert card 2. Remove card 3. Depress handle to open door</p>

October 2006 Room Keys

Nevada – Fitzgerald Casino

New advertising room key, Limericks Steakhouse.

Mfr: None



Contributor: Mary and Joseph MacNeill

Nevada – New York New York Casino

New Zumanity room key..

Mfr: None



Contributor: Larry and Alice Kopp

October 2006 Room Keys

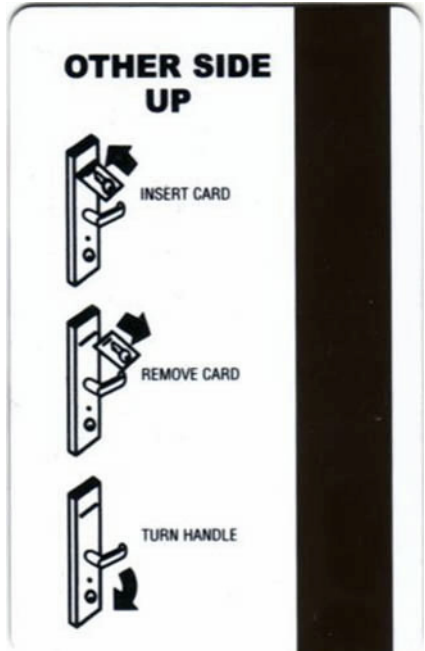
<p>New Jersey – Bally's Casino</p> <p>Latest room key.</p> <p>Mfr: Innovative</p> <p>Contributor: Mary and Joseph MacNeill</p>	 <p>THIS SIDE UP INSERT AND REMOVE</p> <p>BALLY'S ATLANTIC CITY</p> <p>CLARIDGE TOWER AT BALLY'S</p> <p>WILD WILD WEST CASINO BALLY'S</p>	 <p>Insert and Remove Key Card Magnetic Stripe Down</p>  <p>Turn Handle While Green Light is Flashing</p> 
<p>New Jersey – Resorts Casino</p> <p>Latest room key.</p> <p>Mfr: None</p> <p>Contributor: Archie Black</p>	 <p>↑ This Side Up ↑</p> <p>THERE'S MORE TO THE GAME</p> <p>RESORTS atlantic city</p> <p><small>Bet with your head, not over it. Gambling Problem? Call 1-800-CRIBLER.</small></p>	 <p>OTHER SIDE UP</p> <p>INSERT CARD</p>  <p>REMOVE CARD</p>  <p>TURN HANDLE</p> 

October 2006 Room Keys

<p>New Jersey – Resorts Casino Latest room key. Mfr: None</p> <p>Contributor: Archie Black</p>		
<p>New Jersey – Sands Casino Existing room key, casino/hotel will be demolished in the next few months. Mfr: Innovative</p> <p>Contributor: Archie Black</p>		

October 2006 Room Keys

<p>New Jersey – Sands Casino</p> <p>Existing room key, casino/hotel will be demolished in the next few months.</p> <p>Mfr: Innovative</p> <p>Contributor: Archie Black</p>		 <p>1. Fully insert key card and remove. 2. Depress handle and open door.</p> <p>FOR YOUR SECURITY</p> <ul style="list-style-type: none"> • Use safe deposit box for valuables. • Secure deadbolt and doorguard. • Use viewport to ID all visitors. • Employees are required to wear name tags. • Insure that all windows and doors are locked. • Safeguard and keep your room key with you at all times.
<p>New Jersey – Sands Casino</p> <p>Existing room key, casino/hotel will be demolished in the next few months.</p> <p>Mfr: Innovative</p> <p>Contributor: Archie Black</p>		 <p>1. Fully insert key card and remove. 2. Depress handle and open door.</p> <p>FOR YOUR SECURITY</p> <ul style="list-style-type: none"> • Use safe deposit box for valuables. • Secure deadbolt and doorguard. • Use viewport to ID all visitors. • Employees are required to wear name tags. • Insure that all windows and doors are locked. • Safeguard and keep your room key with you at all times.

October 2006 Room Keys

New Jersey – Sands Casino
25th Anniversary room key.

Mfr: Innovative

Contributor: Archie Black

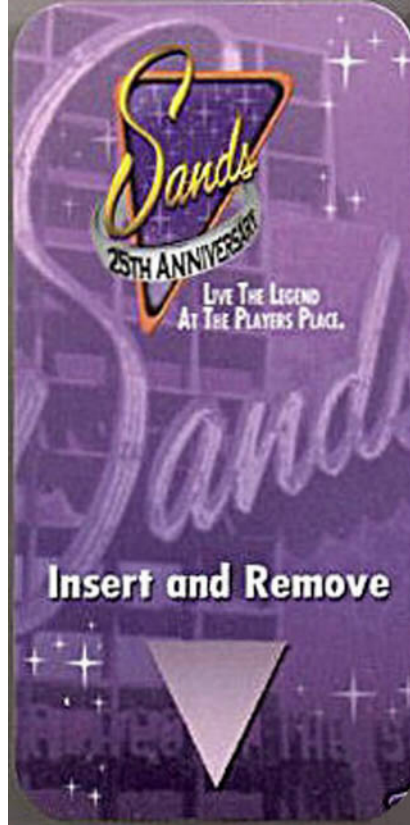

October 2006 Room Keys

New Jersey – Showboat Casino

New design.

Mfr: None

Contributor: Archie Black

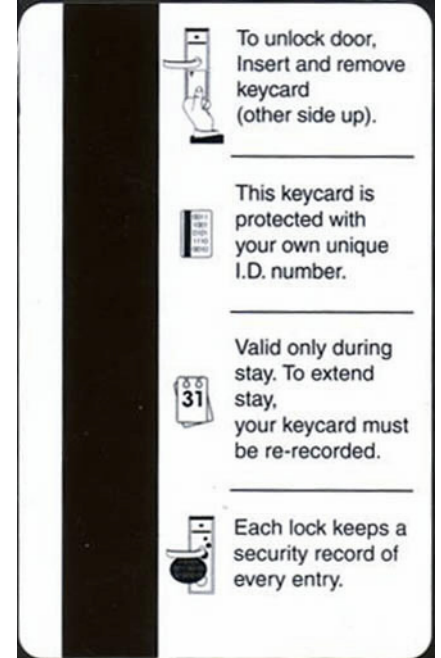
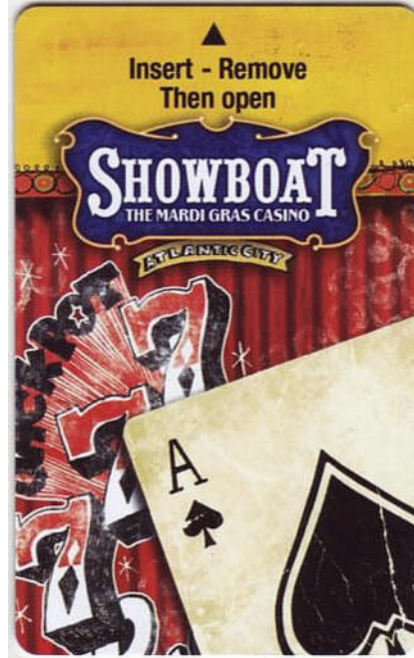

New Jersey – Trump Plaza Casino

New design.

Mfr: Innovative.

Contributor: Archie Black

